

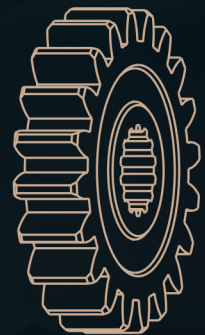

Enduring Strength...

METALIC TECHNOFORGE LIMITED

# Forged For Endurance Machined For Precision

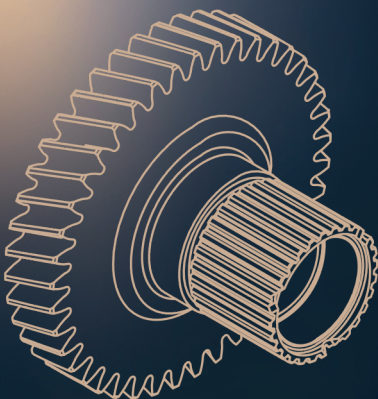
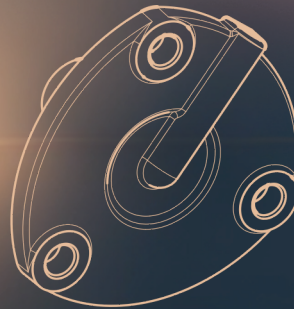
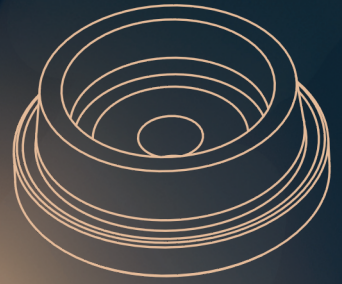

Scan to Know More

① [info@metallictechnoforge.com](mailto:info@metallictechnoforge.com)

🌐 [www.metallictechnoforge.com](http://www.metallictechnoforge.com)

# About Us

Established in 2014, MTF is a leading manufacturer of forged and precision machined parts, proudly IATF 16949 certified. The company supplies to OEMs, Tier 1 and Tier 2 clients across Automotive, Farm Equipment, Construction, Oil & Gas, Hydraulics, and Engineering sectors. With state-of-the-art facilities featuring forging hammers and presses, heat treatment, Gear Profile Grinder, CNC Gear Hobbing, CNC Turning & Milling Centres, Broaching, and advanced supporting machines. MTF ensures precision at every stage. Its quality assurance is backed by advanced testing systems, including Gear Profile Tester, CMM, Microscope, Brinell & Rockwell Hardness Testers and supporting other instruments.

Area:  
20000 sq. mtr.

Team Size:  
200+

Forging Capacity:  
7500 MT / Annum

Machining Capacity:  
3.6 M Pcs/Annum

Sales Revenue:  
11 M Euro

Export Ratio:  
42%

Development Lead Time  
30 days

Green Energy Contribution  
55%



Green  
Energy  
Commitment



Carbon  
Footprint  
Reduction



## Environmental Commitment

MTF reports verified **CBAM** data to EU customers and has its carbon footprint verified under **ISO 14064 & GHG** Protocol. The company's 1 MW Solar Plant cuts **1,450 tons of CO2** per year. MTF is certified with **ISO 16949 | PED & AD 2000 | ISO 14001, ISO 45001** and is dedicated to driving energy efficiency, waste reduction, and resource optimization.



## Infrastructure

### FORGING FACILITIES

- Screw Press – 3 Lines
- Hammer – 2 Lines
- Induction Billet Heater – 5 Lines
- Heat Treatment Furnace – 2 Lines

### MACHINING FACILITIES

- Gear Profile Grinder – Klingenberg Viper 500
- CNC Gear Hobbing – Nidec
- Broaching
- CNC Turning & Milling Centres

### QUALITY FACILITIES

- Gear Profile Tester – Klingenberg P40
- CMM – Ziess
- Contour Tester – Zeiss
- Surface Roughness Tester – Mitutoyo



## Governance & Ethics

MTF has a dedicated ESG Committee for policy oversight and follows an Anti-Corruption & Ethics Policy to ensure transparency. The company's Sustainable Procurement & Supplier Code is aligned with **ISO 2000**, and an annual ESG review is conducted to maintain accountability.



## Our ESG Journey Ahead

MTF is preparing its first ESG-Sustainability Report for 2025 and undergoing **EcoVadis** assessment for global benchmarking. The company is setting 2030 ESG targets aligned with international standards and plans to launch a Sustainability Portal by FY 2026.

# Product Range

## Gears & Shafts



# Gears Blanks



# Hydraulic Cylinder



# Construction Equipment



# General Engineering



## GLOBAL SUPPLY

Germany Italy Finland Austria France Spain Poland Serbia  
USA Canada Brazil Argentina Israel Turkey China



## CERTIFICATION



Headquarter & Manufacturing  
**Gujarat, India**

Wearhouse Facilities  
**Germany / Finland / USA**

✉ [info@metallictechnoforge.com](mailto:info@metallictechnoforge.com)

☎ +91 90333 56105



Scan to Know More